

# DuraLine® PLUS

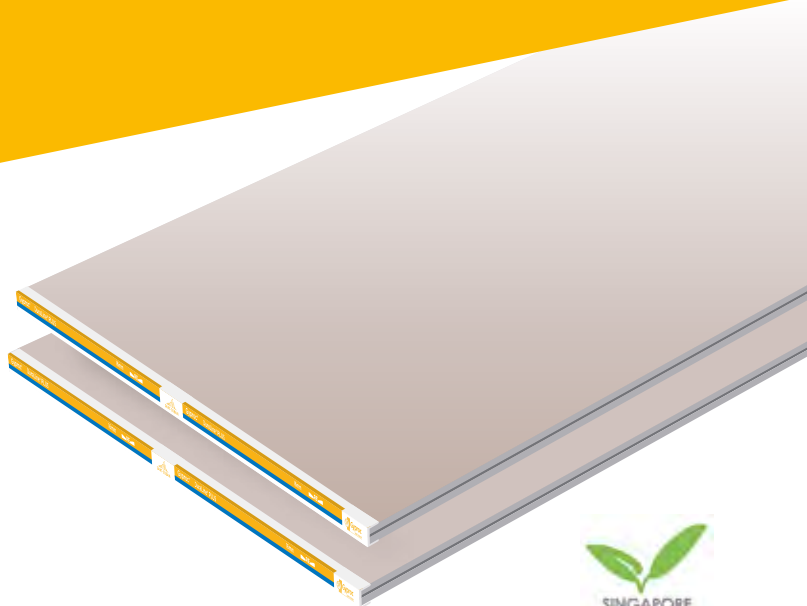

SGBP 2018-1224

## DuraLine®

DuraLine® PLUS is a high impact resistant gypsum board with a high density core that contains glass fibres and fumed silica, which is encased and family bonded to strong paper liners.

Use as Gyproc® Gypwall® ROBUST system, DuraLine® PLUS is universally used for walls that require impact resistance and a durable surface, such as residential, schools and recreational buildings, hospitals and other institutional buildings, public circulation areas of commercial buildings, hotels and industrial premises.

DuraLine® PLUS is also available in a moisture-resistant variant known as DuraLine® MR.

## CHARACTERISTICS

The gypsum core consists of a higher density mass core with glass fibre and fumed silica, and is encased and firmly bonded to strong paper liners. Achieves a severe duty rating in a single boarded partition system and satisfies as BS 5234: Part 2 for strength and robustness requirements.

## RECOMMENDED USE

- Universally used for wall systems that require impact resistance

## PRODUCT FORMAT

Thickness	16mm	19mm
Nominal Weight	14.50kg/m <sup>2</sup>	17.10kg/m <sup>2</sup>
Nominal Sheet Size*	1220mm x 2440mm	
Edge Type		

## FIRE RATING

- Classified as Class 0 material in accordance to building regulation
- Available up to 4-hours fire rating (Gypwall® ROBUST system) in accordance to BS 476:Part 22
- Non-combustible in accordance to BS 476: Part 4
- Low fire propagation in accordance to BS 476: Part 6
- Class 1 surface spread of flame in accordance to BS 476: Part 7

## MANUFACTURING SPECIFICATIONS

- In compliance with ASTM C 1396 and BS EN 520

## HANDLING AND WORKABILITY

- Crack-free
- Seamless and smooth finishing

## THERMAL INSULATION

- Recommended design thermal conductivity, k-value = 0.18 W/m.k

## HEALTH AND ENVIRONMENTAL CONTRIBUTIONS

- Made from 100% natural gypsum
- Recyclable material, hence environmentally friendly and certified with Green Product Certification Scheme
- Does not produce toxic fumes or hazardous substances that are harmful to health
- Product is manufactured in a facility that is certified to standards of ISO 14001 and ISO 9002.

# Gyproc® ROBUST Wall System

Gyproc® ROBUST Wall System is a specially designed impact resistant partition system that offers superior performance alternative to traditional brick walls. The highly durable internal partition system is ideal for homes and high traffic commercial areas where strong and robust walls are required.

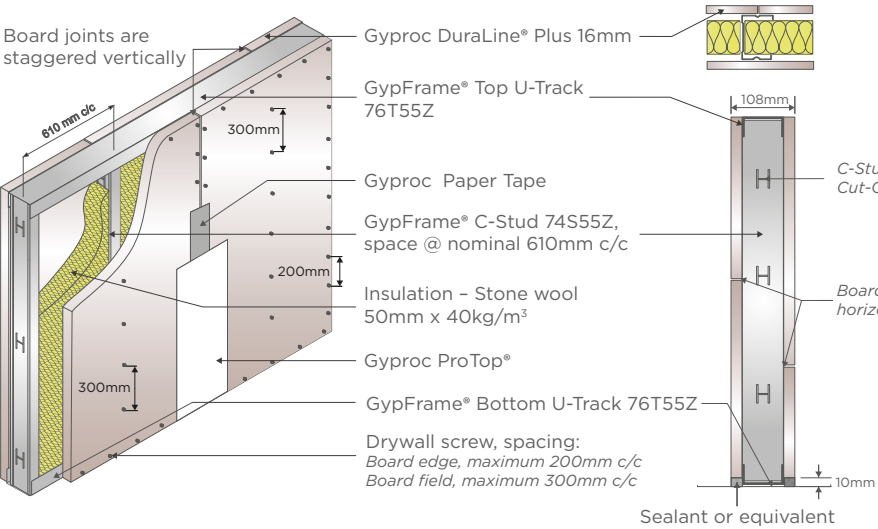

## GypWall® ROBUST 74S55Z.16DP.SW.1HR

Parameters	Values
Overall System Weight	33.0kg/m²
Maximum Height (L/240 @ 0.25kPa)	4.13m
Fire Rating (BS476:PART22)	1 Hour
STC Rating¹	51

\*Wall height more than 3.80m please consult Gyproc® for recommendation

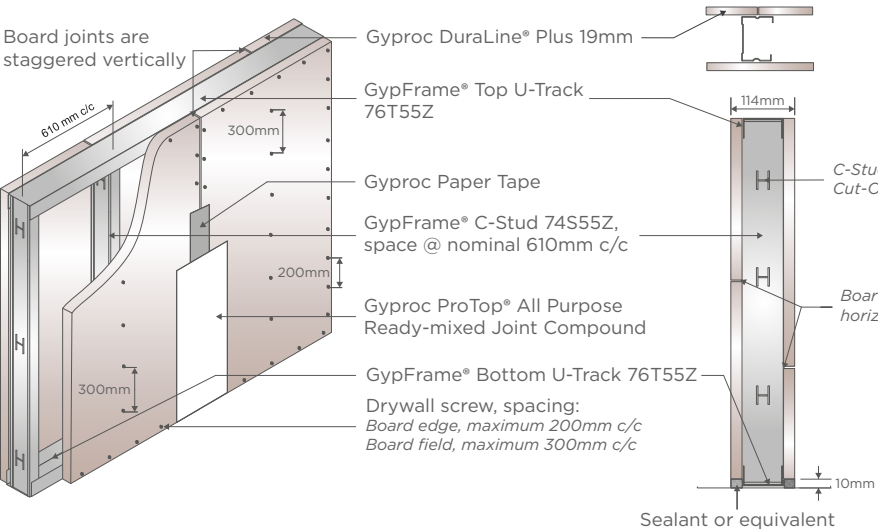

## GypWall® ROBUST 74S55Z.19DP.1HR

Parameters	Values
Overall System Weight	35.30kg/m²
Maximum Height (L/240 @ 0.25kPa)	4.10m
Fire Rating (BS476:PART22)	1 Hour
STC Rating¹	44

\*Wall height more than 3.80m please consult Gyproc® for recommendation



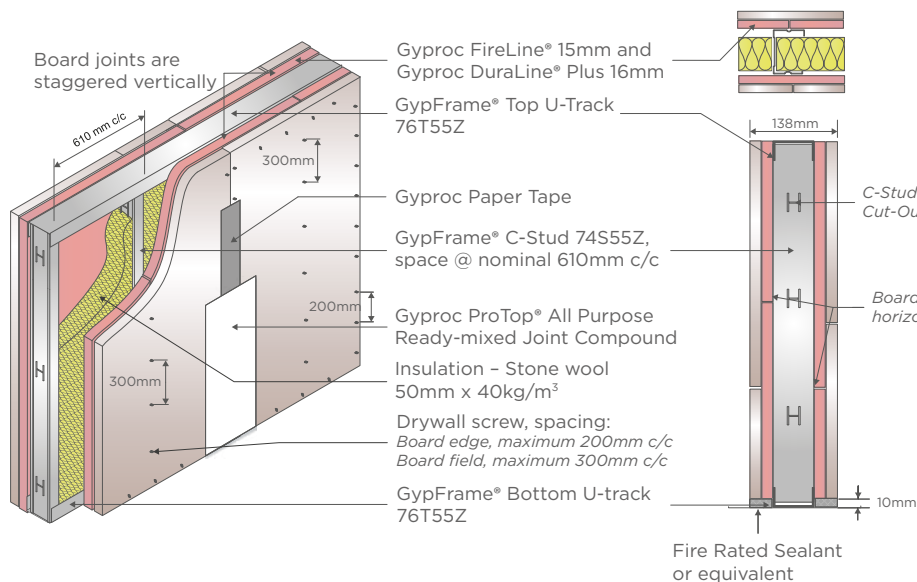

## GypWall® ROBUST 74S55Z.15FL16DP.SW.2HR

Parameters	Values
Overall System Weight	58.00kg/m <sup>2</sup>
Maximum Height (L/240 @ 0.25kPa)	3.80m
Fire Rating (BS476:PART22)	2 Hours
STC Rating <sup>1</sup>	60

\*Wall height more than 3.80m please consult Gyproc® for recommendation

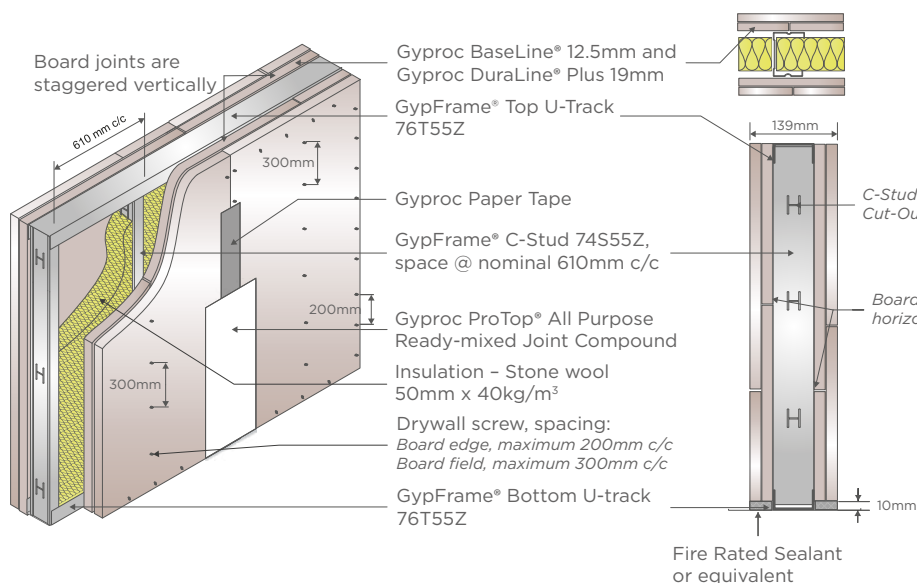

## GypWall® ROBUST 74S55Z.BL19DP.SW.2HR

Parameters	Values
Overall System Weight	53.10kg/m <sup>2</sup>
Maximum Height (L/240 @ 0.25kPa)	3.80m
Fire Rating (BS476:PART22)	2 Hours
STC Rating <sup>1</sup>	59

\*Wall height more than 3.80m please consult Gyproc® for recommendation





# DuraLine® PLUS



SCAN ME



**Saint-Gobain Malaysia Sdn. Bhd.**(636775-T)  
No.1, Jalan Sultan Mohamad 4  
Kawasan Perindustrian Bandar  
Sultan Suleiman, Port Klang,  
42000 Selangor, Malaysia.  
Tel: +603 3169 5588  
Fax: +603 3169 5688  
Email: [solutions.my@saint-gobain.com](mailto:solutions.my@saint-gobain.com)  
[www.gyproc.my](http://www.gyproc.my)

SINGAPORE OFFICE  
**Saint-Gobain (Singapore) Pte.Ltd.**  
2 Venture Drive, #09-10/11/12/13/14  
Vision Exchange  
Singapore 608526  
Tel: +65 6330 8288  
[www.gyproc.sg](http://www.gyproc.sg)