

# DuraLine® MR



## DuraLine® MR

DuraLine® MR is the moisture-resistant variant of DuraLine® PLUS. It is a high impact-resistant gypsum board with water repellent additives added to its high density core containing glass fibres and fumed silica.

DuraLine® MR is conventionally used for walls that require both moisture and impact resistance, such as in residential and commercial buildings, hospitals, schools, and hotels. DuraLine® MR is also highly suitable as a backing board for ceramic tiling in intermittent moisture areas, and also for external soffits in sheltered positions.

## CHARACTERISTICS

A gypsum board with a high density core containing glass fibres and fumed silica mixed with a specially formulated additive to enhance moisture resistance, all encased and firmly bonded to strong paper liners.

## RECOMMENDED USE

- Universally used for walls that require both moisture and impact resistance.

## PRODUCT FORMAT

Thickness	16mm	19mm
Nominal Weight	14.50kg/m <sup>2</sup>	17.10kg/m <sup>2</sup>
Nominal Sheet Size*	1220mm x 2440mm	
Edge Type		

## FIRE RATING

- Classified as Class O material in accordance to building regulations.
- Available up to 4 hours fire rating (GypWall® ROBUST system) in accordance with BS 476: Part 22.
- Non-combustible in accordance with BS 476: Part 4.
- Low fire propagation in accordance with BS 476: Part 6.
- Class 1 surface spread of flame in accordance with BS 476: Part 7.

## MANUFACTURING SPECIFICATIONS

- 100% compliance with ASTM C1396 and BS EN 520

## HANDLING AND WORKABILITY

- Crack-free
- Seamless and smooth finishing

## THERMAL INSULATION

- Recommended design thermal conductivity, k-value = 0.18 W/m.k

## HEALTH AND ENVIRONMENTAL CONTRIBUTIONS

- Made from 100% natural gypsum
- Recyclable material, hence environmentally friendly and certified with Green Product Certification Scheme
- Does not produce toxic fumes or hazardous substances that are harmful to health
- Product is manufactured in a facility that is certified to standards of ISO 14001 and ISO 9002.

# Gyproc® ROBUST and AQUA Wall System

Gyproc® ROBUST and AQUA Wall System is a specially designed walls that offers both moisture and impact resistance properties. The highly durable internal partition system is ideal for homes of high traffice areas where strong, moisture and robust wall are required.

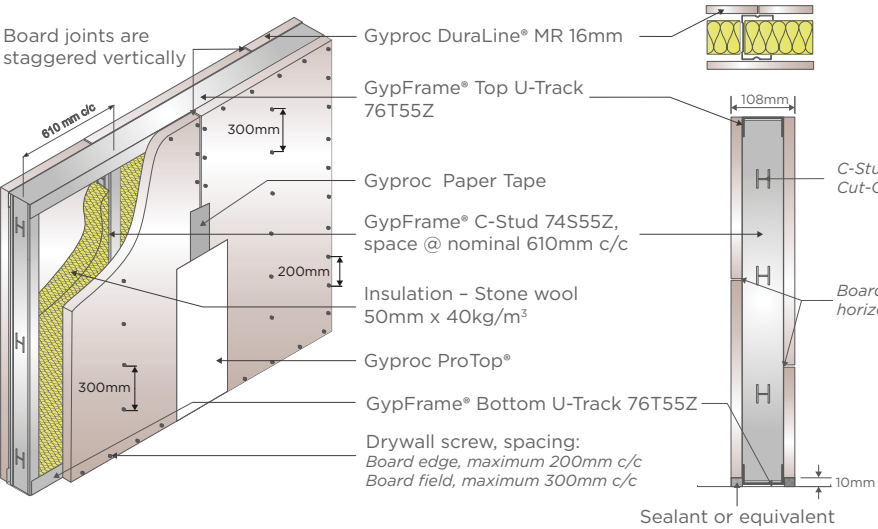

## GypWall® ROBUST 74S55Z.16DRMR.SW.1HR

Parameters	Values
Overall System Weight	33.0kg/m²
Maximum Height (L/240 @ 0.25kPa)	4.13m
Fire Rating (BS476:PART22)	1 Hour
STC Rating¹	51

\*Wall height more than 3.80m please consult Gyproc® for recommendation

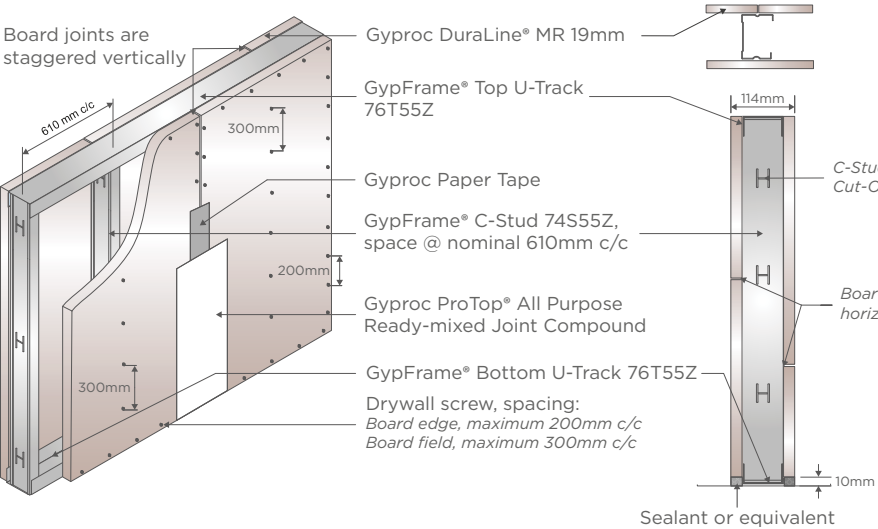

## GypWall® ROBUST 74S55Z.19DRMR.1HR

Parameters	Values
Overall System Weight	35.30kg/m²
Maximum Height (L/240 @ 0.25kPa)	4.10m
Fire Rating (BS476:PART22)	1 Hour
STC Rating¹	44

\*Wall height more than 3.80m please consult Gyproc® for recommendation



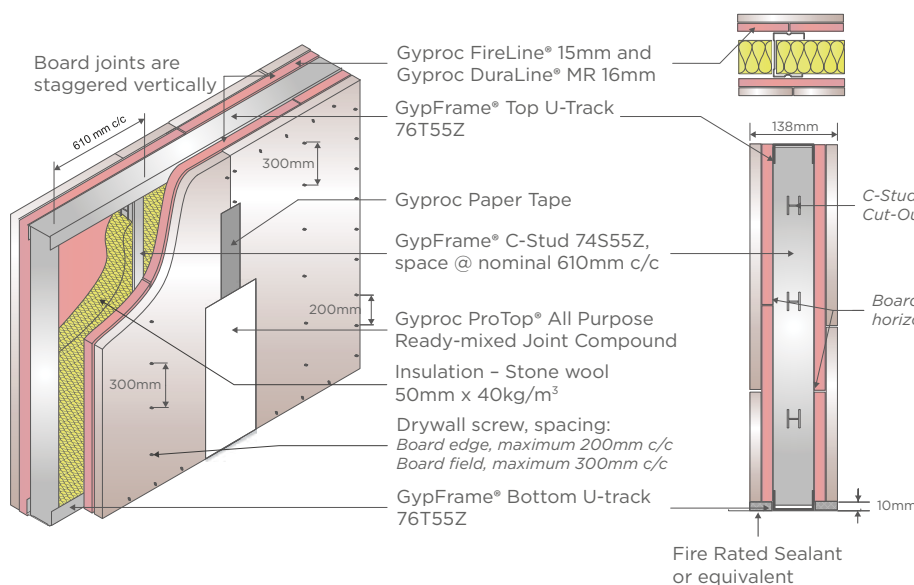

### GypWall® ROBUST 74S55Z.15FL16DRMR.SW.2HR

Parameters	Values
Overall System Weight	58.00kg/m²
Maximum Height (L/240 @ 0.25kPa)	3.80m
Fire Rating (BS476:PART22)	2 Hours
STC Rating¹	60

\*Wall height more than 3.80m please consult Gyproc® for recommendation

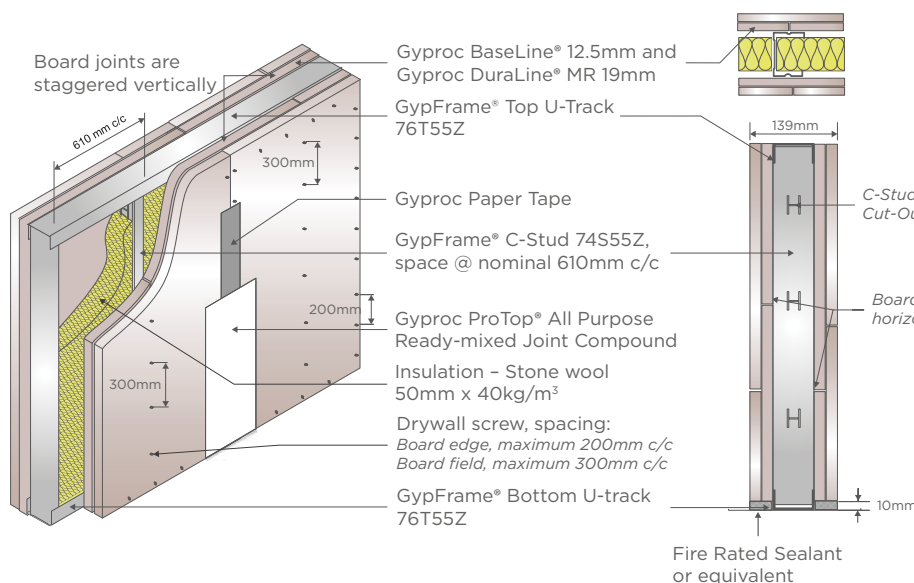

### GypWall® ROBUST 74S55Z.BL19DRMR.SW.2HR

Parameters	Values
Overall System Weight	53.10kg/m²
Maximum Height (L/240 @ 0.25kPa)	3.80m
Fire Rating (BS476:PART22)	2 Hours
STC Rating¹	59

\*Wall height more than 3.80m please consult Gyproc® for recommendation





# DuraLine® MR



SCAN ME



**Saint-Gobain Malaysia Sdn. Bhd.**(636775-T)  
No.1, Jalan Sultan Mohamad 4  
Kawasan Perindustrian Bandar  
Sultan Suleiman, Port Klang,  
42000 Selangor, Malaysia.  
Tel: +603 3169 5588  
Fax: +603 3169 5688  
Email: [solutions.my@saint-gobain.com](mailto:solutions.my@saint-gobain.com)  
[www.gyproc.my](http://www.gyproc.my)

SINGAPORE OFFICE  
**Saint-Gobain (Singapore) Pte.Ltd.**  
2 Venture Drive, #09-10/11/12/13/14  
Vision Exchange  
Singapore 608526  
Tel: +65 6330 8288  
[www.gyproc.sg](http://www.gyproc.sg)